

BOTTOM BRACKET CUPS

OS-FIT

1 - TECHNICAL SPECIFICATIONS/COMPATIBILITY

IMPORTANT!

When using these bottom bracket cups with the EPS drivetrain, the bottom bracket cable guide tube must be fitted before starting installation.



OVER TORQUE™	Thread		Press-Fit				
	ITA	BSA	BB30	BB86	PF30	BB RIGHT	BB386
	70x (36x24 tpi)	68x (1,37"x24 tpi)	68x42	86,5x41	68x46	79x46	86,5x46

BB30 (68 x42)

IMPORTANT!

The bottom bracket shell must provide passage of the rear derailleur cable that prevents possible contact between the cable and the crankset axle.

2 - INTERFACE WITH FRAME

2.1 - M.C. BB386 SHELL EVO L = 86.5 mm x Ø 46 mm (Fig. 1)

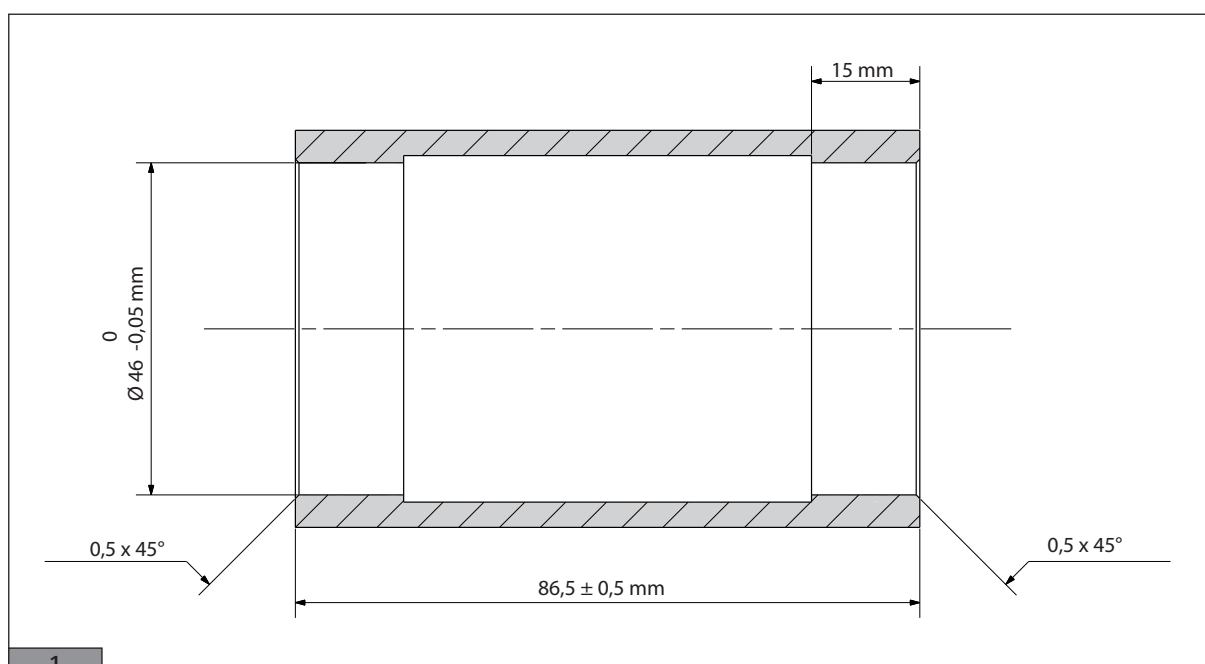

2.2 - M.C. PRESS FIT BB30 SHELL L = 68 mm x Ø 46 mm (Fig. 2)

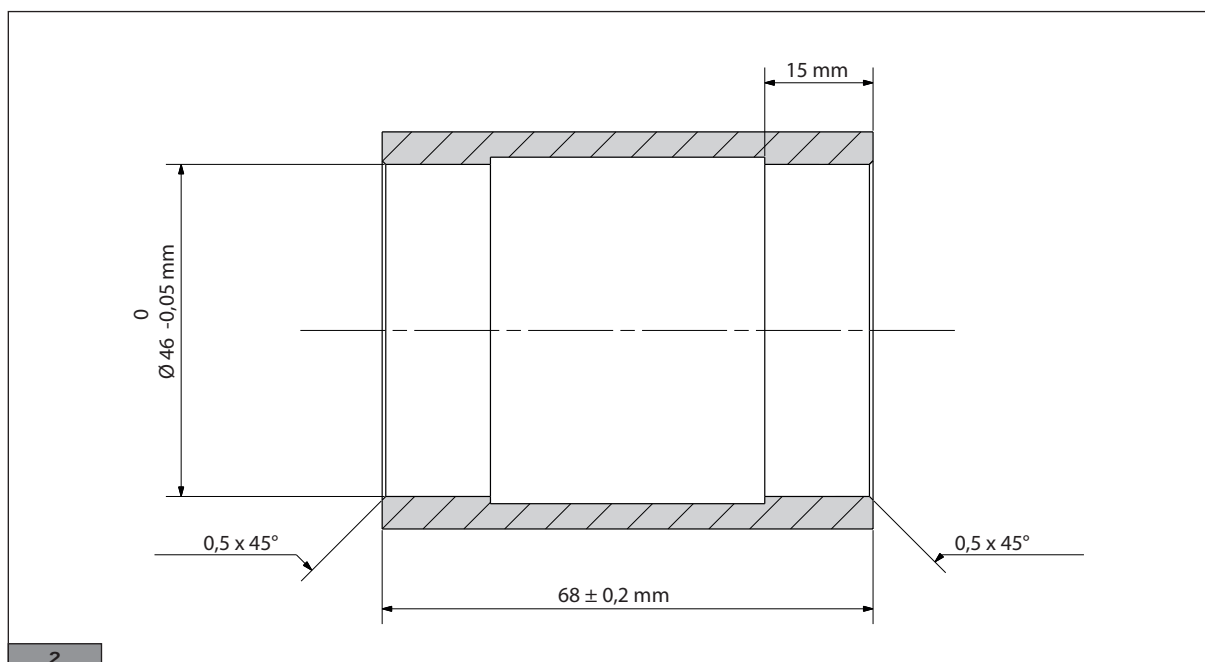

2.3 - M.C. BB30 SHELL L = 68 mm x Ø 42 mm (Fig. 3)

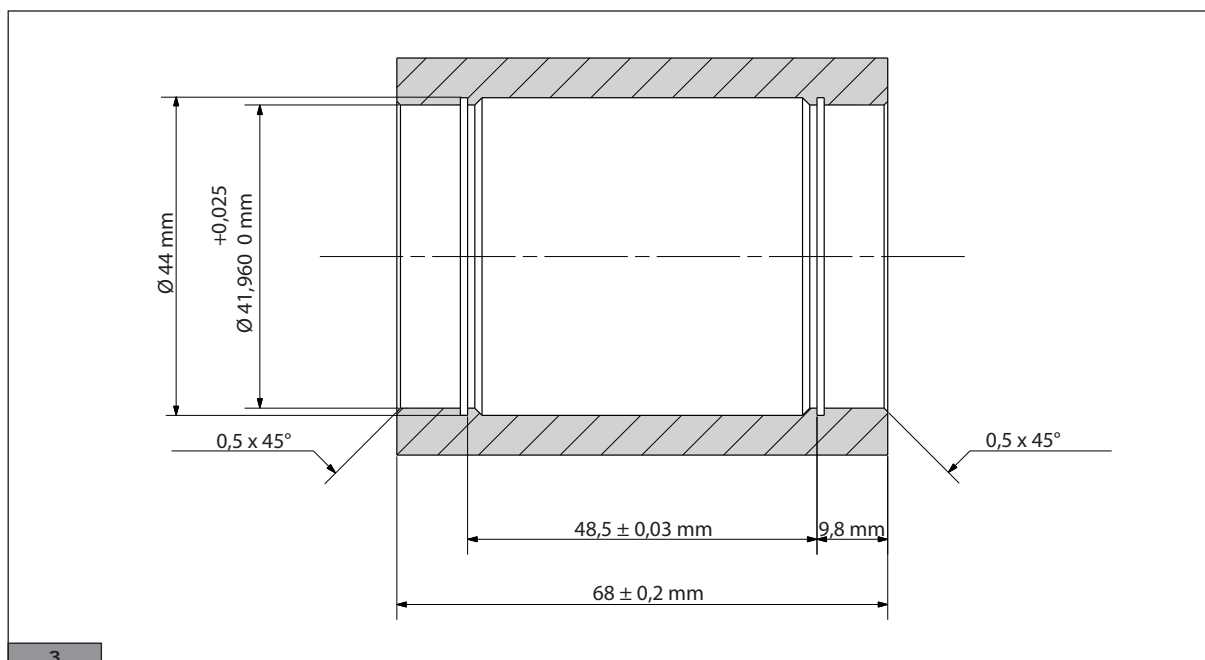

When installing a crankset on a frame, the bottom bracket shell must comply with the tolerances specified. If the mating tolerances comply with specifications (indicated in Fig.1, Fig. 2 and Fig. 3), correct operation is ensured by the matching dimensions. In the event that the bottom bracket shell does not respect the required tolerances, or in case of any doubt, we recommend gluing the bottom bracket cups to the bottom bracket shell.

3 - TOOLS

To mount the OS-FIT bottom bracket cups use a BB30 bearing press fitting tool.

4 - MOUNTING BOTTOM BRACKET CUPS

Grease the retaining seals on the BB 386 EVO and PF BB30, in order to reduce friction between the seals and the crankset axle at minimum.

IMPORTANT

In case of using the crankset with the EPS drivetrain, it is necessary to follow the instructions below:

- For BB 386 EVO and PF BB30 bottom bracket shells insert an adequate axle cover cylinder in the bottom bracket shell itself.
- For BB30 bottom bracket shells, in order to prevent contact of the rear derailleur cable with the crankset axle, the bottom bracket shell must provide passage of the rear derailleur cable separate from the shell.

CAUTION

For BB30 bottom bracket shells Seeger rings must be fitted for positioning the bearings inside the bottom bracket shell.

4.1 - MOUNTING OS-FIT BOTTOM BRACKET CUPS

- Thoroughly clean the inner surfaces of the bottom bracket shell which will mate with the bottom bracket cups (Fig. 4) with isopropyl alcohol and a cloth. Leave to dry completely.

- Thoroughly clean the outer surfaces of the bottom bracket cups (Fig. 4) with isopropyl alcohol and a cloth, and leave to dry. Do not touch the cleaned surfaces.

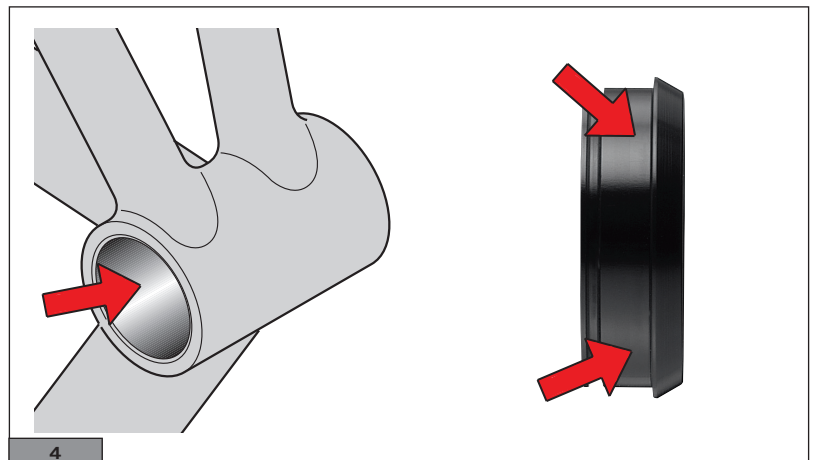

- To accelerate the curing time of the Loctite adhesive which will be used later in the procedure, apply Loctite Primer 7471 or Loctite Primer 7649 on all the surfaces of the bottom bracket shell which will be in contact with the bottom bracket cups (Fig. 5). Leave to dry for approximately 5 minutes then clean off any excess primer with isopropyl alcohol.

- Repeat the previous procedure on the outer surface of the bottom bracket cups and leave to dry for approximately 5 minutes.



- Use a brush to carefully apply Loctite 603 (quicker drying) or Loctite 609 on the outer surfaces of the bottom bracket cups (Fig. 6).
- Clean the brush after use with isopropyl alcohol.



- Press both bottom bracket cups into the bottom bracket until the bottom bracket cups encounter resistance and the O-ring enters the bottom bracket itself and is no longer visible (Fig. 7).

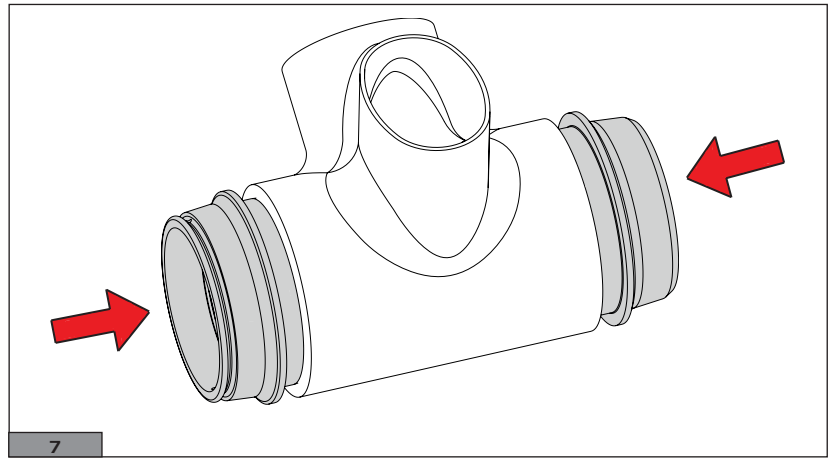

- Engage the tool UT-BB140 into the right hand bottom bracket cup to bring it into contact with the inner surface in the bottom bracket cup.
- Tighten the tool UT-BB140 into the left hand bottom bracket cup to bring it into contact with the bottom bracket cup itself (Fig. 8).

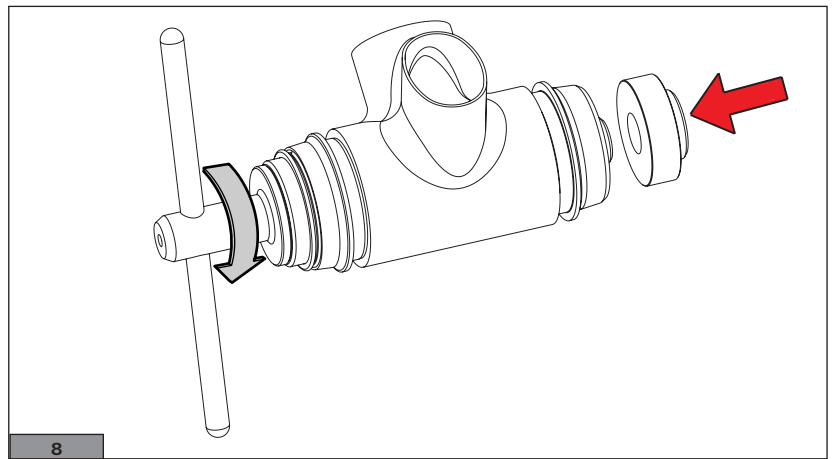

- Turn the lever of tool UT-BB140 clockwise until both bottom bracket cups are flush with the bottom bracket (Fig. 9).

Before removing the tool, check that the bottom bracket cups are installed correctly on the bottom bracket (Fig. 9).

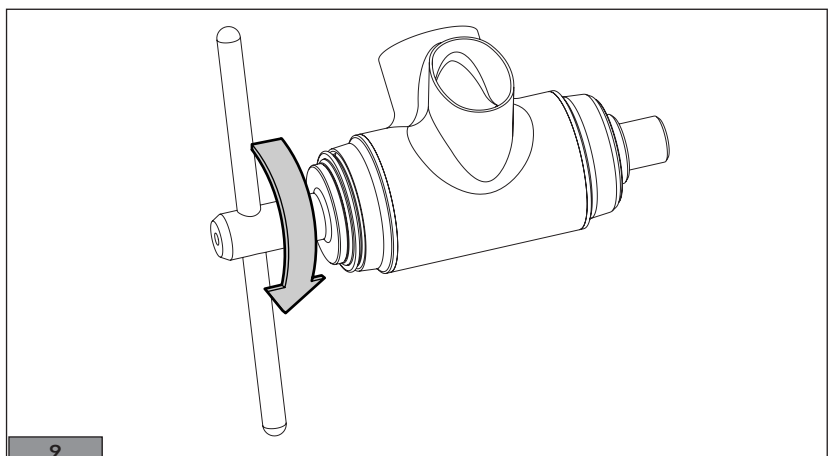

- Turn the lever of tool UT-BB140 anticlockwise to unscrew the left hand bottom bracket cup completely, then remove the screw (Fig. 10).
- Clean off any excess Loctite with isopropyl alcohol and wait approximately 24 hours before using the bicycle to be sure that the adhesive has cured completely.

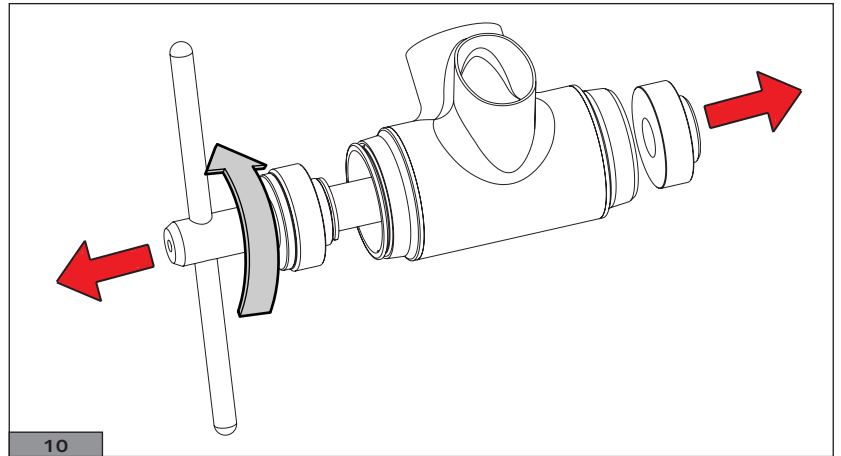

5 - MAINTENANCE

• The maintenance intervals are purely approximate and may vary significantly depending on the intensity and conditions of use (for example: competitions, rain, salted winter roads, weight of the athlete, etc.). Schedule the appropriate maintenance with your mechanic.

1) Removal of bottom bracket cups for BB386EVO and PFBB30 bottom bracket shells:

- If the bottom bracket cup bearings need to be replaced, the entire bottom bracket cup MUST be replaced. Replacing the bearings is absolutely prohibited in order to prevent misalignment between the bearing and the bottom bracket cup.
- For removal of the bottom bracket cup use a bearing puller tool (Beta/Usag).

2) Removal of bottom bracket cups for BB30 bottom bracket shells:

- To remove the bottom bracket cups, make up of the individual bearings, use a bearing puller tool (Beta/Usag), taking care for the presence of the Seeger rings near the bearings.

CAUTION

- Dirt seriously damages the bicycle and its components. Rinse, wash and dry your bike carefully after using it.
- Never wash your bicycle using pressurised water. Pressurised water - even from a normal garden hose - may infiltrate through the seals and into your Campagnolo® components, causing irreparable damage. Wash your bicycle and its Campagnolo® components cleaning delicately with water and neutral soap. Dry with a soft cloth: Never use abrasive or metallic sponges.